

5

SCREENING

5.8

COUPLING PIECE



The coupling piece connects the THG40 gear rack with the pullpush tube.

Two types of coupling piece are available. Coupling piece $\phi 27$ is suitable for the $\phi 27 \times 1.5\text{mm}$ pull-push tube and coupling piece $\phi 32$ for the $\phi 32 \times 1.5\text{mm}$ pull-push tube.

The coupling pieces are manufactured from galvanised solid steel and are supplied with 2 clamping bushes as standard.

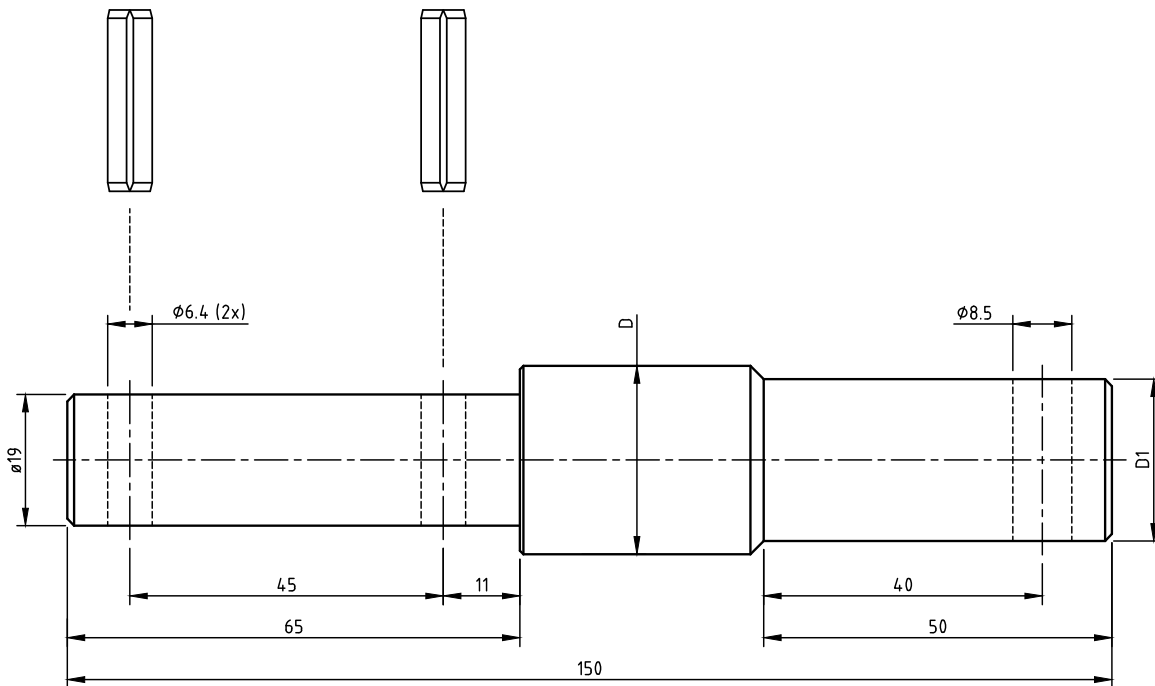

Description	D [mm]	D1 [mm]	m [kg]	Article number
Coupling piece $\phi 27$	27	23.2	0.45	P.KS.D27
Coupling piece $\phi 32$	32	27.8	0.60	P.KS.D32