



194 Series

ELECTRIC MOTOR-PUMP UNITS



lavaggio industriale
industrial cleaning



idropulitrici
pressure washers



processi industriali
industrial processes



autolavaggio
car wash



produzione
manufacturing



agricoltura
agriculture



municipality



misting



pulizia tubazioni
sewer jetting



cantieri ed edilizia
construction industry

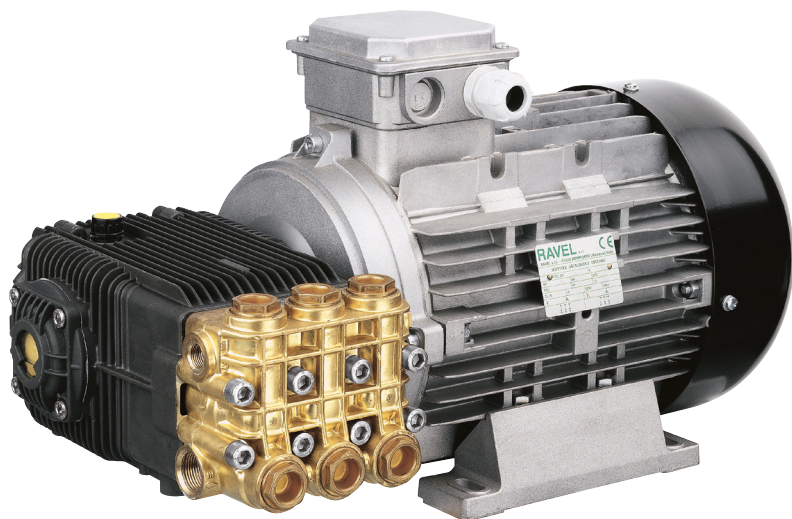

GR. 100 motor hollow shaft

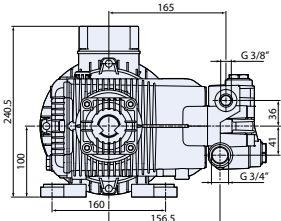
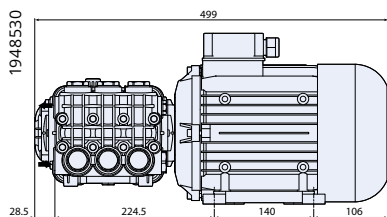

GR. 112 motor hollow shaft

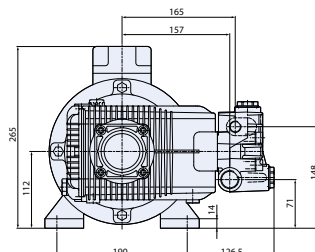
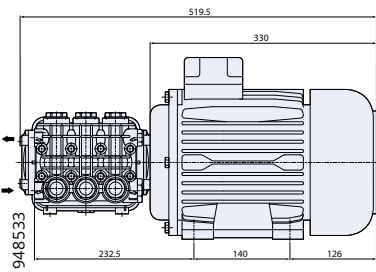

GR. 132 S motor hollow shaft

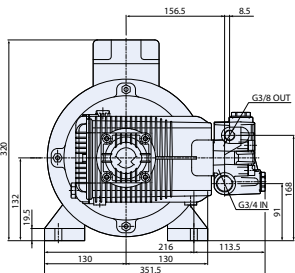
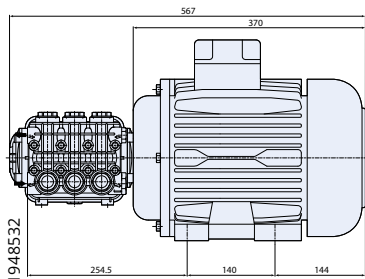

GR. 132 L motor hollow shaft

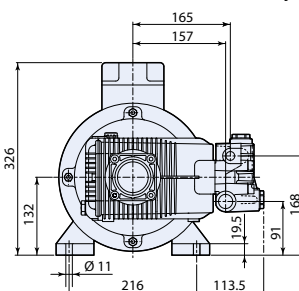
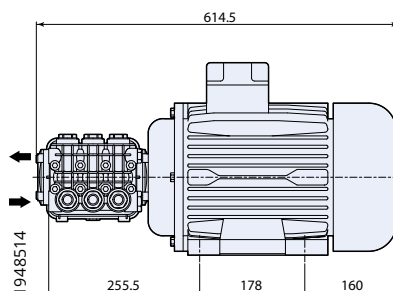

COD	3 ~	l/min	gpm	bar	psi	hp	kW	N° giri/1'	V 3-50Hz	Gr.	kg
HXW 1450 rpm											
HXW 15.15 ET	20871	15	3,96	150	2200	5,5	4	1450	230/400	100	33
HXW 15.20 ET	20872	15	3,96	200	2900	7,5	5,5	1450	230/400	112	39
HXW 21.20 ET	20224	21	5,55	200	2900	10	7,5	1450	230/400	132 S	63
HXW 26.15 ET	20225	26	6,87	150	2200	10	7,5	1450	230/400	132 S	63
HXW 30.10 ET	20227	30	7,92	100	1450	7,5	5,5	1450	230/400	112	39
HXW 30.15 ET	20228	30	7,92	150	2200	10	7,5	1450	230/400	132 S	63
HXW 30.20 ET	20229	30	7,92	200	2900	15	11	1450	230/400	132 L	70



testa in ottone
brass head



bielle in alluminio
connecting-rods in aluminium



3~50Hz
frequenza motore
motor frequency

194 Series

ELECTRIC MOTOR-PUMP UNITS

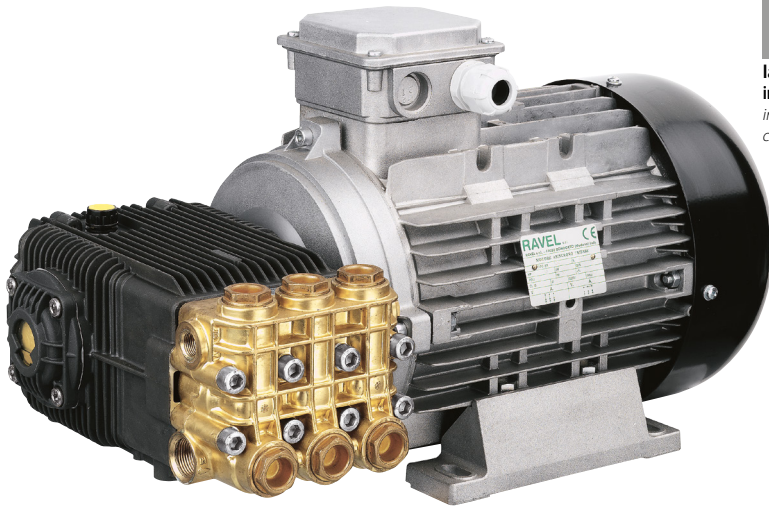

- 
lavaggio industriale
industrial cleaning
- 
idropultrici
pressure washers
- 
processi industriali
industrial processes
- 
autolavaggio
car wash
- 
produzione
manufacturing
- 
agricoltura
agriculture
- 
municipality
- 
misting
- 
pulizia tubazioni
sewer jetting
- 
cantieri ed edilizia
construction industry

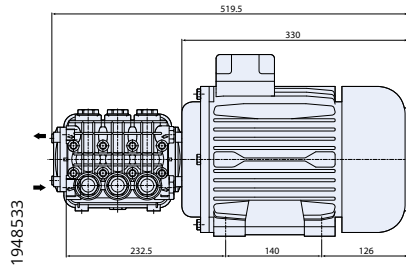

GR. 112 motor hollow shaft

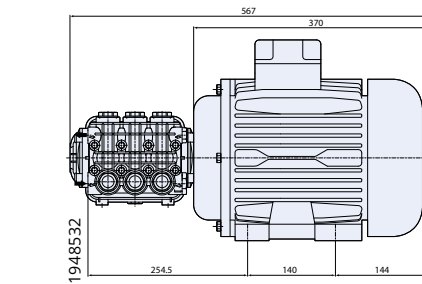
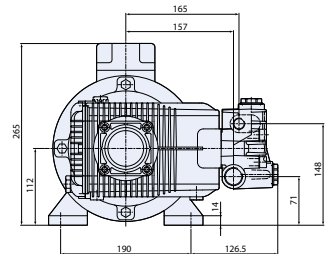

GR. 132 S motor hollow shaft

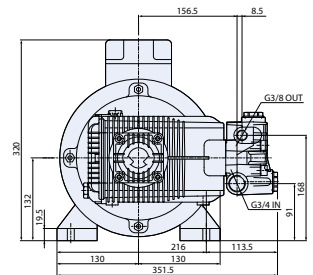

COD	3 ~	MAX		MAX						KG NET	
		l/min	gpm	bar	psi	hp	kW	N° giri/1'	V	Gr.	kg
HXWL 1450 rpm											
HXWL 42.07 ET	21183	42	11,09	70	1000	7,5	5,5	1450	230/400 ^c	112	39
HXWL 42.10 ET	21184	42	11,09	100	1450	10	7,5	1450	230/400 ^c	132 S	63
HXWA 1750 rpm											
HXWA 4 G20 ET	20782	15,1	4	140	2000	5,5	4	1750	230/400 ^d	112	33
HXWA 4 G30 ET	20783	15,1	4	205	3000	7,5	5,5	1750	230/400 ^d	112	39



testa in ottone
brass head



bielle in alluminio
connecting-rods in aluminium



frequenza motore
motor frequency

c) 3~ 50 Hz • d) 3~ 60 Hz